

1. Find a suitable mounting location away from hot or moving components. Keep the catch can(s) mounted vertically to allow oil to collect in the bottom section. As shown, a custom mounting bracket may need to be made to interface with the provided catch can bracket.

Reference the last page for bracket hole-pattern and dimensions.

Apply a thread locker (such as blue Loctite) to the included M5x.8mm screws and torque to 68 in-lbs.



2. Either port can be used as the inlet or the outlet. Flow direction is not critical. The inside diameter of the hose used should match the factory hose. NOTE: Before installing the adapter fittings, lubricate the O-rings with engine oil.

For 20-0005/8-FL catch cans: A variety of adapter fittings and hose are available from radiumauto.com. The ports are threaded for 10AN ORB fittings.

For 20-1806/8/10-FL catch can kits: Lubricate the PushLok hose end barbs and fully insert the hose. As shown, PushLok hose ends do NOT require clamps.



3. Using the oil dipstick, check the fluid level occasionally. If any oil registers, properly dispose by either unscrewing the bottom plug or unscrewing the bottom half of the catch can(s). If the vehicle is regularly tracked, the dipstick should be checked more frequently. A 10mm deep socket can be used to remove the dipstick if tight.

The condensing media should also be inspected regularly for excessive debris which can cause a restriction in the crankcase ventilation system. The stainless steel media will not corrode and can easily be removed and cleaned with a degreaser spray.



4. Petcock Drain Kit Only (sold separately)

Replace bottom plug with included barb fitting and remotely mount the petcock valve(s). Keep hose away from hot and moving components.

For Dual Catch Cans Only: Depending on the PCV system, there may be a dynamic pressure difference in each can. In this case, there should be one valve for every catch can, independently. However, the barbed outlet on the ball valves can be connected together using a 1/4" TEE (not supplied) and the internal fluid can be dumped using one tube for simplicity.



BASIC PLUMBING EXAMPLES

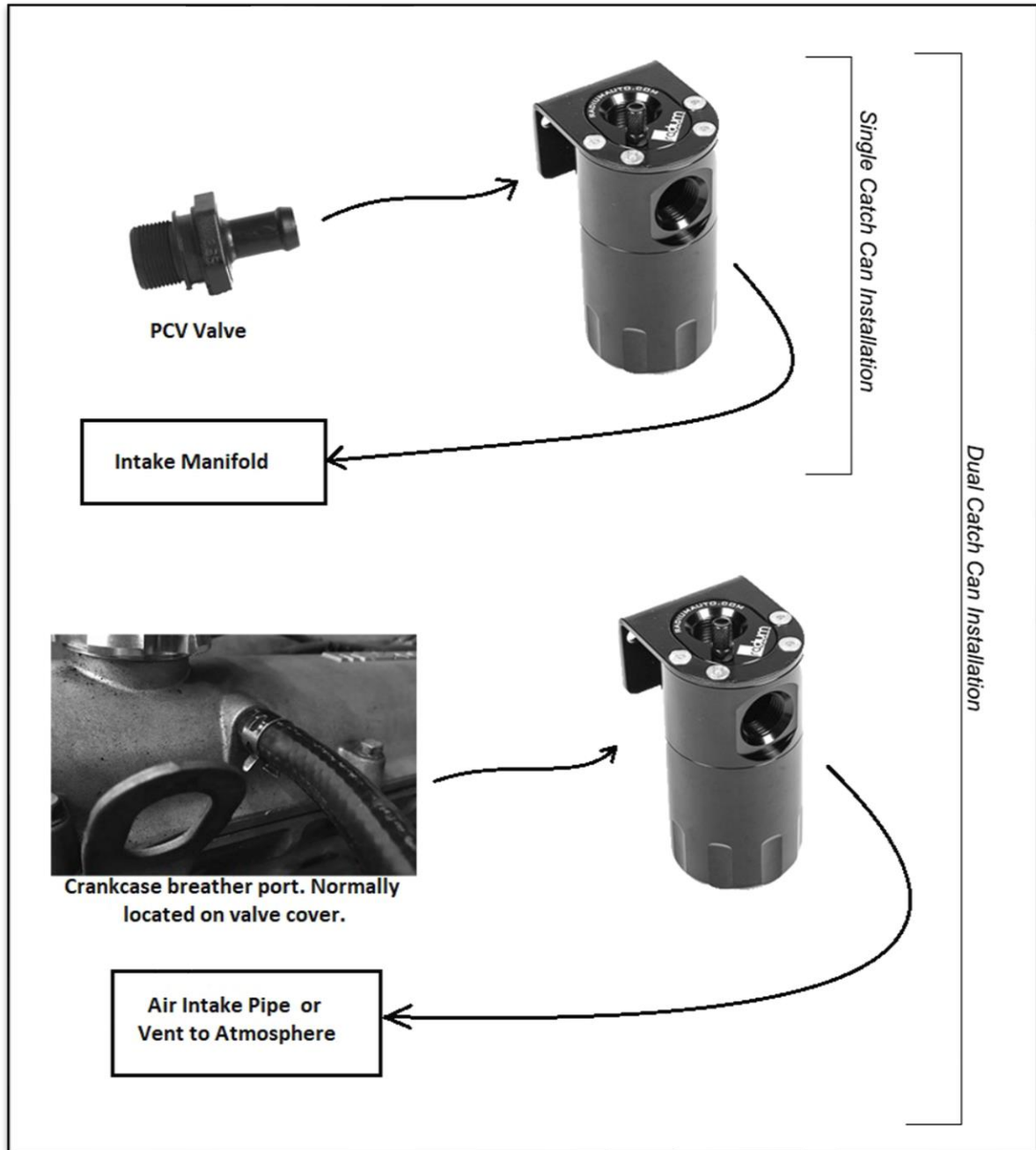

Continued on next page

